

## TERMINALS OF ECU

### 1. INSPECT INSTRUMENTAL PANEL J/B (BODY ECU)

- (a) Inspect Fuse
  - (1) Inspect DOOR 25 A and ECU-B 7.5 A fuses.
- (b) Inspect Body ECU
  - (1) Disconnect connectors IA, IB, IL, IM, IN and IJ of the I/P J/B.
  - (2) Check the voltage and continuity of each terminal of the vehicle's connector.

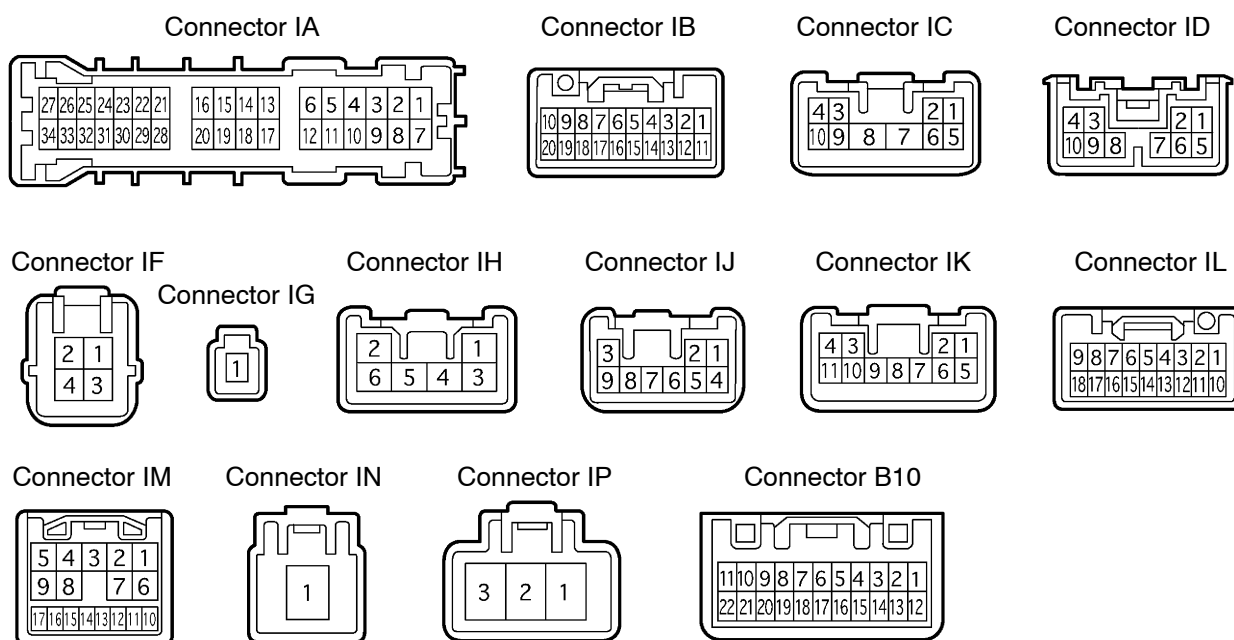
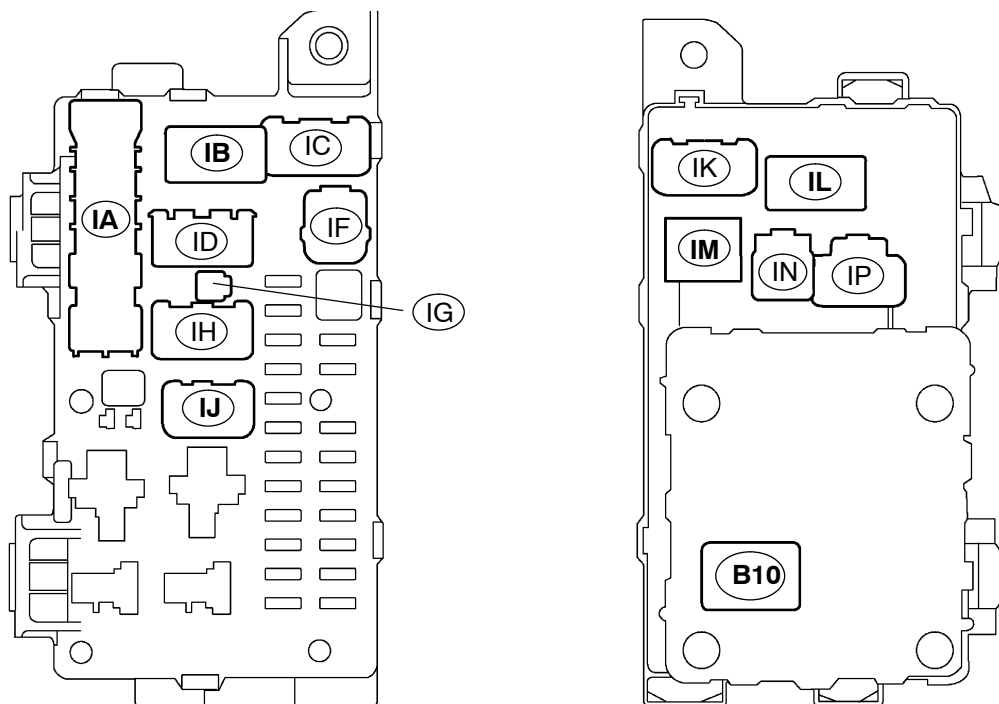

**Standard:**

Tester connection	Condition	Specified condition
IA-5 (KSW) – Ground	No key in ignition switch lock cylinder → Yes	No continuity → Yes
IJ-2 (E) – Ground	Constant	Continuity
IB-13 (DCTY) – Ground	Driver door fully closed → Opened	No continuity → Yes
IN-1 (DOOR) – Ground	Constant	10 – 14 V
IL-13 (ECUB) – Ground	Constant	10 – 14 V
IM-12 (PCTY) – Ground	Passenger door fully closed → Opened	No continuity → Yes
IM-12 (PCTY) – Ground	Rear right door fully closed → Opened	No continuity → Yes
IM-12 (PCTY) – Ground	Rear left door fully closed → Opened	No continuity → Yes
IA-28 (HAZ) – Ground	Hazard warning Switch OFF	10 – 14 V

If the condition is not as specified, it means that the vehicle malfunctions.

- (3) Connect the connector and check the voltage of each terminal of the connector.

**Standard:**

Tester connection	Condition	Specified condition
IA-5 (KSW) – Ground	No key in ignition switch lock cylinder → Yes	10 – 14 V → 0 V
B10-16 (RDA) – Ground	IG switch OFF, No Insert key in driver door lock cylinder, All door opened and Transmitter switch OFF → ON	1 V or less → 6 V → 1 V or less
IA-28 (HAZ) – Ground	IG switch OFF, No Insert key in driver door lock cylinder, All door opened and Transmitter switch OFF → ON	10 – 14 V → 1 V or less

If the value is not as specified, it means the body ECU or I/P J/B assembly malfunctions.